

**UTILITY SINK FAUCET
K-7319**

ADA

Features

- Brass construction
- Brass valve bodies
- Valvet® valves
- Adjustable flanges
- Stationary gooseneck spout
- For 8" (203 mm) centers
- 7-1/2" (191 mm) spout reach
- 1/2" NPT inside threaded inlets
- Rosespray
- Lower flow aerator options available (refer to the Kohler Price Book)
- 2.2 gallons (8.3 L) per minute maximum flow rate

Codes/Standards Applicable

Specified model meets or exceeds the following at date of manufacture:

- ADA
- ASME A112.18.1/CSA B125.1
- ICC/ANSI A117.1
- Energy Policy Act of 2005
- NSF 61
- All applicable US Federal and State material regulations

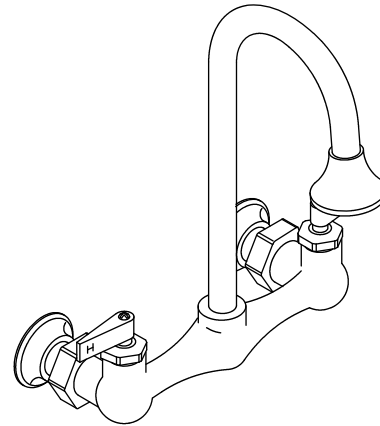

Colors/Finishes

- CP: Polished Chrome
- BN: Brushed Nickel
- Other: Refer to Price Book for additional colors/finishes

Specified Model

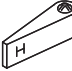
Model	Description	Cross Handles			Lever Handles		
							
K-7319-3	Utility sink faucet	<input type="checkbox"/> CP	<input type="checkbox"/> BN	<input type="checkbox"/> Other_____			
K-7319-4	Utility sink faucet (shown)				<input type="checkbox"/> CP	<input type="checkbox"/> BN	<input type="checkbox"/> Other_____

Product Specification

The two-handle service sink faucet shall be of brass construction with brass valve bodies. Product shall have a maximum flow rate of 2.2 gallons (8.3 L) per minute with lower flow aerator options available (refer to the Kohler Price Book). Product shall feature Valvet valves, 7-1/2" (191 mm) spout reach, rosespray, and stationary gooseneck spout. Product shall feature adjustable flanges and 1/2" NPT inside threaded inlets. Product shall be for 8" (203 mm) centers. Faucet shall be Kohler Model K-7319-____-____.

TRITON®

Installation Notes

Install this product according to the installation guide.

ADA compliant when installed to the specific requirement of the regulation.

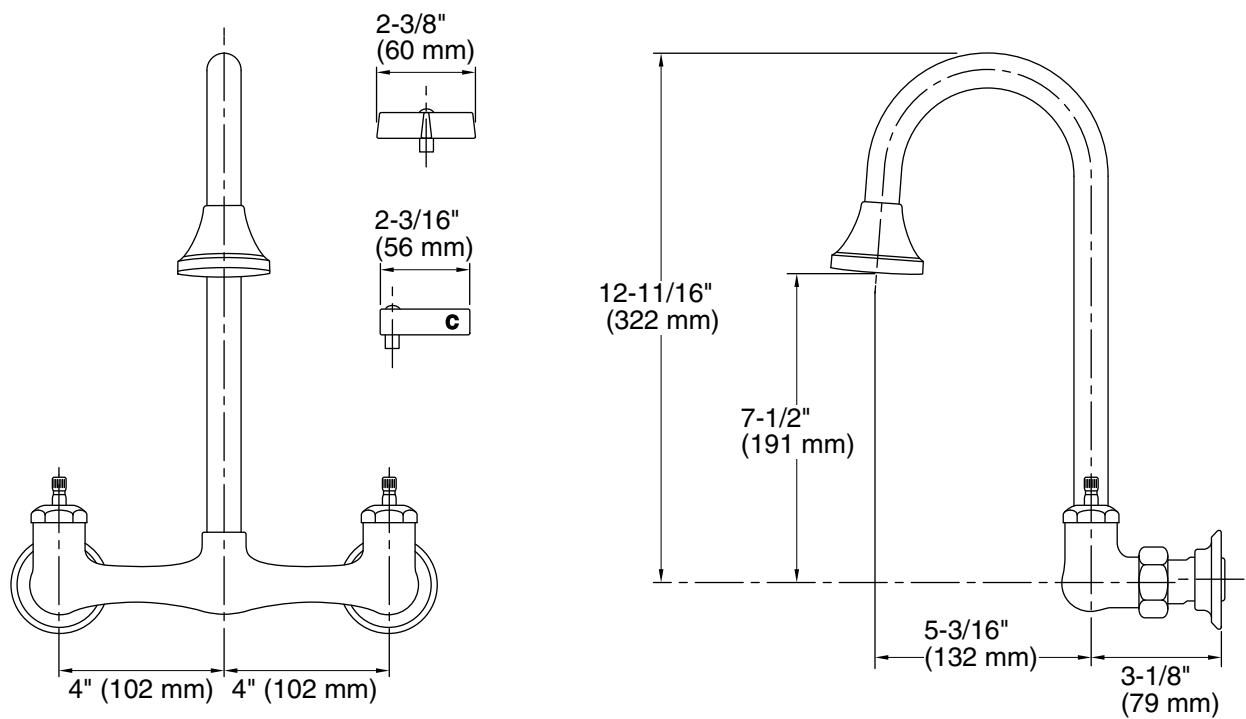

Product Diagram