

Features

- *Flipstream Technology™*
- *Four unique, experiential spray patterns: Koverage™ Kotton™ Komotion™ Kurrent™*
- *Sleek contemporary design*
- *Adjustable angle for various user heights*

FOUR-FUNCTION HANDSHOWER

K-17492
ALSO K-45426

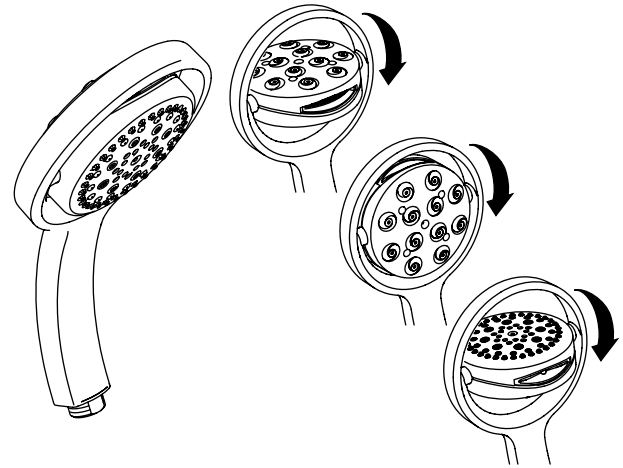

Codes/Standards Applicable

Specified model meets or exceeds the following:

- *ASME A112.18.1/CSA B125.1*

Colors/Finishes

- CP: Polished Chrome
- Other: Refer to Price Book for additional colors/finishes

Accessories

- CP: Polished Chrome

Specified Model

Model	Description	Colors/Finishes	
K-17492	Four-function handshower – 2.5 gpm (9.5 lpm)	<input type="checkbox"/> CP	<input type="checkbox"/> Other _____
K-45426	Four-function handshower – 2.0 gpm (7.6 lpm)	<input type="checkbox"/> CP	<input type="checkbox"/> Other _____
Required Accessories			
K-8593	72" (1829 mm) metal shower hose OR	U	<input type="checkbox"/> CP
K-9514	60" (1524 mm) metal shower hose		<input type="checkbox"/> CP

Product Specification

Four-function handshower shall feature a sleek contemporary design with Flipstream Technology. Handshower shall have four unique, experiential spray patterns: Koverage, Kotton, Komotion, and Kurrent. Handshower shall have adjustable angle for various user heights. Four-function handshower shall be Kohler Model K-17492-____ or K-45426-____.

FLIPSIDE™ 02

Installation Notes

Install this product according to the installation guide.

Plumbing codes require an atmospheric vacuum breaker (such as Kohler Model K-9660) be installed in-line with handshowers. Please consult with local plumbing officials.

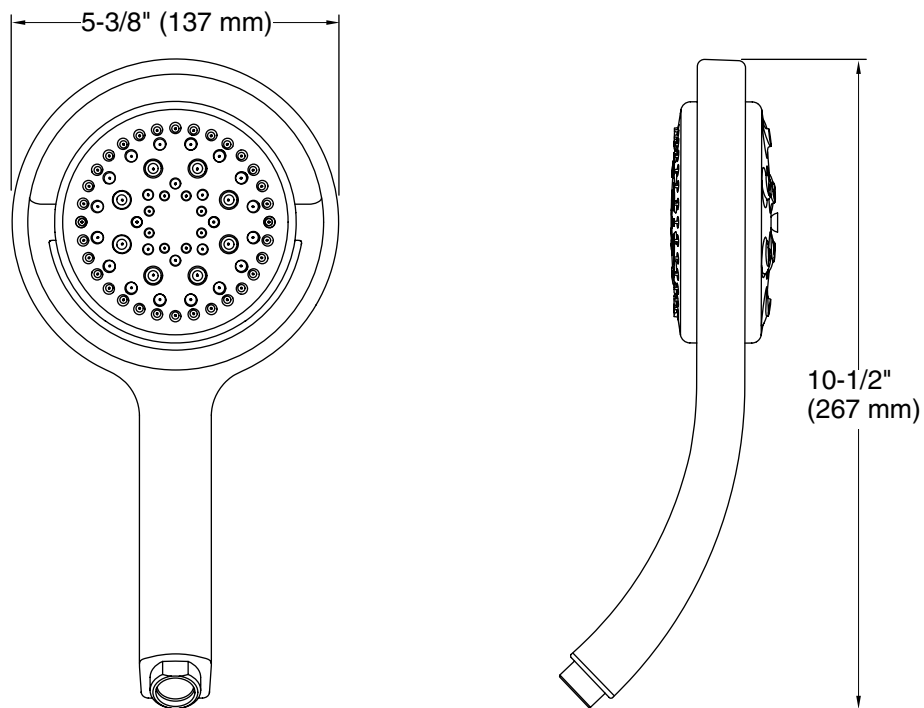

Product Diagram