

Features

- Vitreous china
- Ledge-back
- With hanger
- With overflow
- Drilled for concealed arm carrier
- 8" (203 mm) centers (K-1723), 4" (102 mm) centers (K-1729), or single-hole (K-1721)
- 20" (508 mm) x 18-1/4" (464 mm)

WALL-MOUNT BATHROOM SINK

K-1721

ALSO K-1723, K-1729

ADA

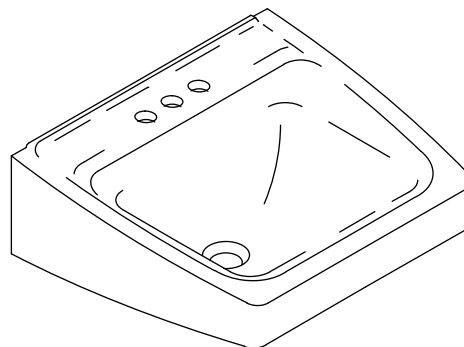

Codes/Standards Applicable

Specified model meets or exceeds the following:

- ADA
- ASME A112.19.2/CSA B45.1
- ICC/ANSI A117.1

Colors/Finishes

- 0: White
- Other: Refer to Price Book for additional colors/finishes

Accessories:

- CP: Polished Chrome

Specified Model

| Model | Description | Colors/Finishes | |
|--------------------------------|-----------------------------------|-----------------------------|-------------------------------------|
| K-1721 | Single-hole bathroom sink | <input type="checkbox"/> 0 | <input type="checkbox"/> Other_____ |
| K-1723 | 8" (203 mm) centers bathroom sink | <input type="checkbox"/> 0 | <input type="checkbox"/> Other_____ |
| K-1729 | 4" (102 mm) centers bathroom sink | <input type="checkbox"/> 0 | <input type="checkbox"/> Other_____ |
| Recommended Accessories | | | |
| K-8998 | P-Trap | <input type="checkbox"/> CP | |

Product Specification

The wall-mount bathroom sink shall be made of vitreous china. Bathroom sink shall be ledge-back with hanger. Bathroom sink shall have overflow. Bathroom sink shall be drilled for concealed arm carrier. Bathroom sink shall have 8" (203 mm) centers (K-1723), 4" (102 mm) centers (K-1729), or be single-hole (K-1721). Bathroom sink shall be 20" (508 mm) in length and 18-1/4" (464 mm) in width. Bathroom sink shall be Kohler Model K-_____-_____.

CHESAPEAKE™

Technical Information

| | |
|-------------------------------------------------|-----------------------------|
| Fixture*: | |
| Basin area | 21" (533 mm) x 12" (305 mm) |
| Water depth | 4-7/8" (124 mm) |
| Drain hole | Ø 1-3/4" (44 mm) |
| * Approximate measurements for comparison only. | |

| Holes | K-1723 | K-1729 | K-1721 |
|--------|------------------|------------------|------------------|
| Spout | Ø 1-3/8" (35 mm) | Ø 1-1/4" (32 mm) | Ø 1-3/8" (35 mm) |
| Faucet | Ø 1-3/8" (35 mm) | Ø 1-1/4" (32 mm) | NA |

Included component:

Hanger

64839

Installation Notes

Install this product according to the installation guide.

Supplied hanger not used with concealed arm carrier.

Will comply with **ADA** when installed per section 606 Lavatories of the Act.

Concealed Arm Hole Locations

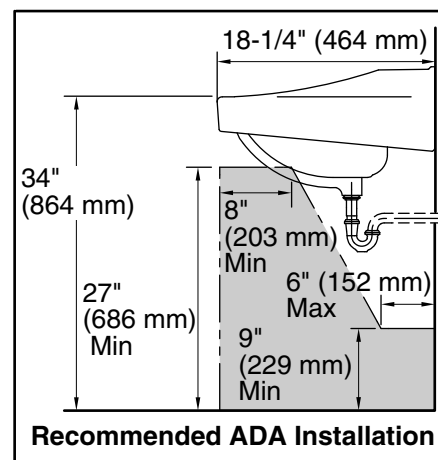
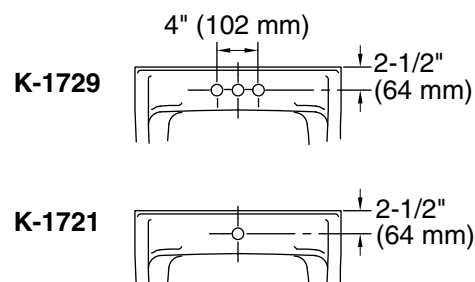
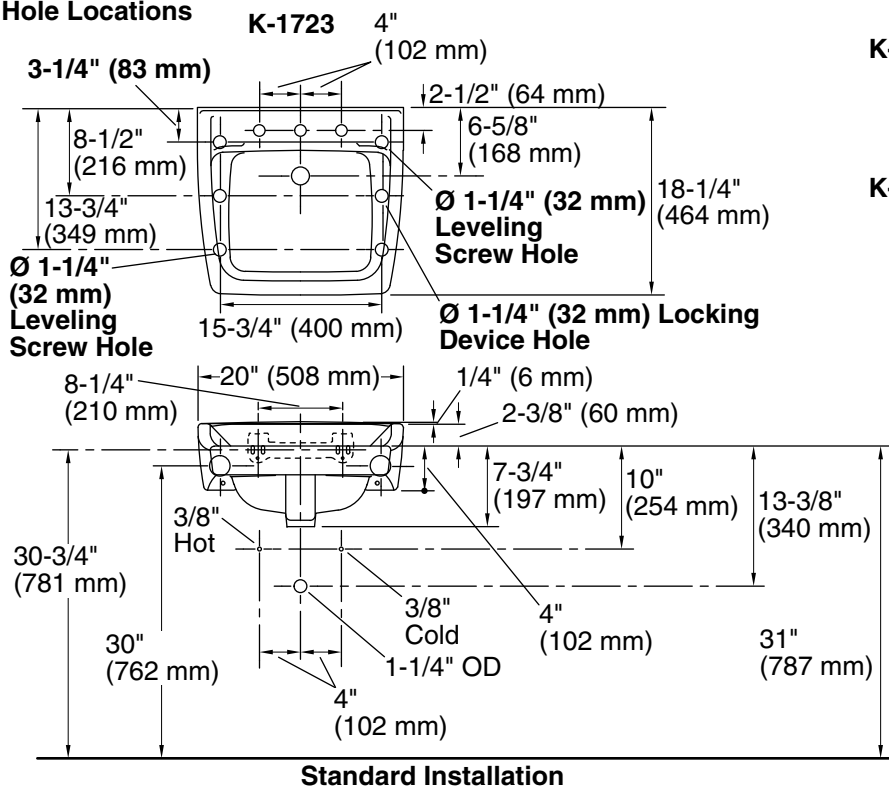

Product Diagram

CHESAPEAKE™ WALL-MOUNT BATHROOM SINK

Page 2 of 2
112667-4-CF

THE BOLD LOOK
OF **KOHLER**®